

### Product Information

- Fanfolding for paper tickets (singlewise)
- High processing speed: 10000 cards/h
- Variable definition of batch size
- Electronical batch control

### Información sobre el producto

- Plegadora de tipo leporello en posición individual para tickets de papel
- Alta velocidad de elaboración de 10000 tarjetas por hora
- Variable definición de batch size
- Batch control electrónico

### Information sur le produit

- Pliage en accordéon en couche individuelle pour tickets en papier
- Vitesse de traitement élevée de l'ordre de 10000 cartes par heure
- Définition variable de la taille des lots
- Contrôle électronique des lots

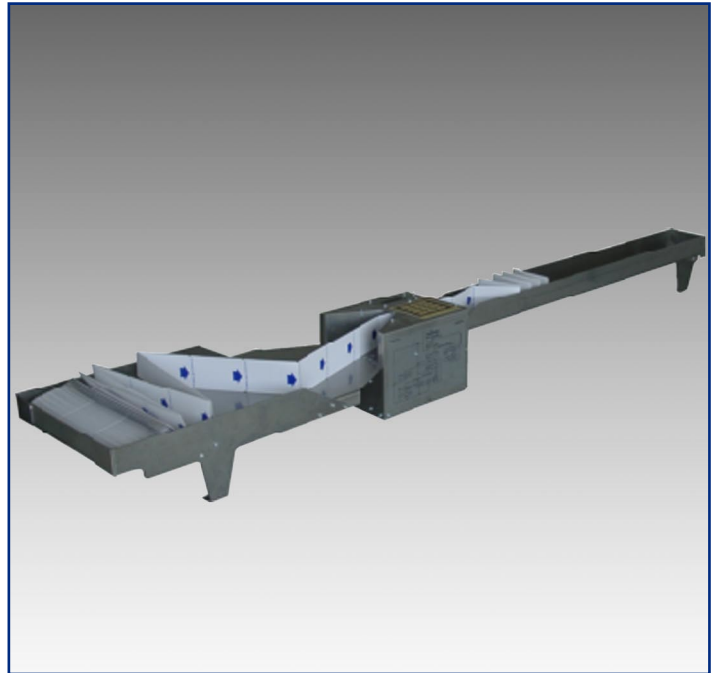

### FOLDERING DEVICE

### PLEGADORA

### PLIEUSE

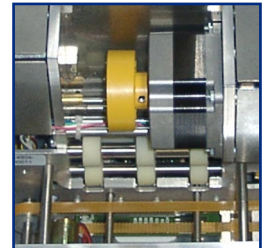

CCS Challenge Card Systems GmbH  
Rombacher Hütte 12a  
44795 Bochum  
Germany  
Tel. +49 (0)234 94391 - 0  
Fax +49 (0)234 94391 - 99  
info@ccs-cardtec.com  
www.ccs-cardtec.com



**CCS**  
built-in reliability

### Dimensions

W 1580 mm H 160 mm D 290 mm

### Power Supply

230 V AC / 50 Hz

### Cards

Thickness: 0.16 mm  
Format: ISO 0.5  
Format: 54 x 85.6 mm  
Material: paper, compound

### Capacity

Max. 10000 card/h

### Interface

Stand alone unit

### Electronic Control

Via single chip processor

### Environment

Range of temperature: 5 - 45 °C  
Air humidity (RH): 20 - 80 %  
non condensing  
Vibration: 10 - 55 Hz  
2 mm amplitude  
along axis x, y and z  
for max. 30 minutes

### Motor

24 V DC geared motor

### Card Detection Sensors

3 x photocells

### Display

2 lines by 16 characters

### Keypad

Numeric foil keypad

### Maintenance and Service

Every 4 months or every 500 000 tickets

### Reliability

MTBF\*: > 20 000 h  
MCBF\*: > 200 000 tickets  
MTTR: < 1 h in workshop

*\* without wear parts*